

RH2538V

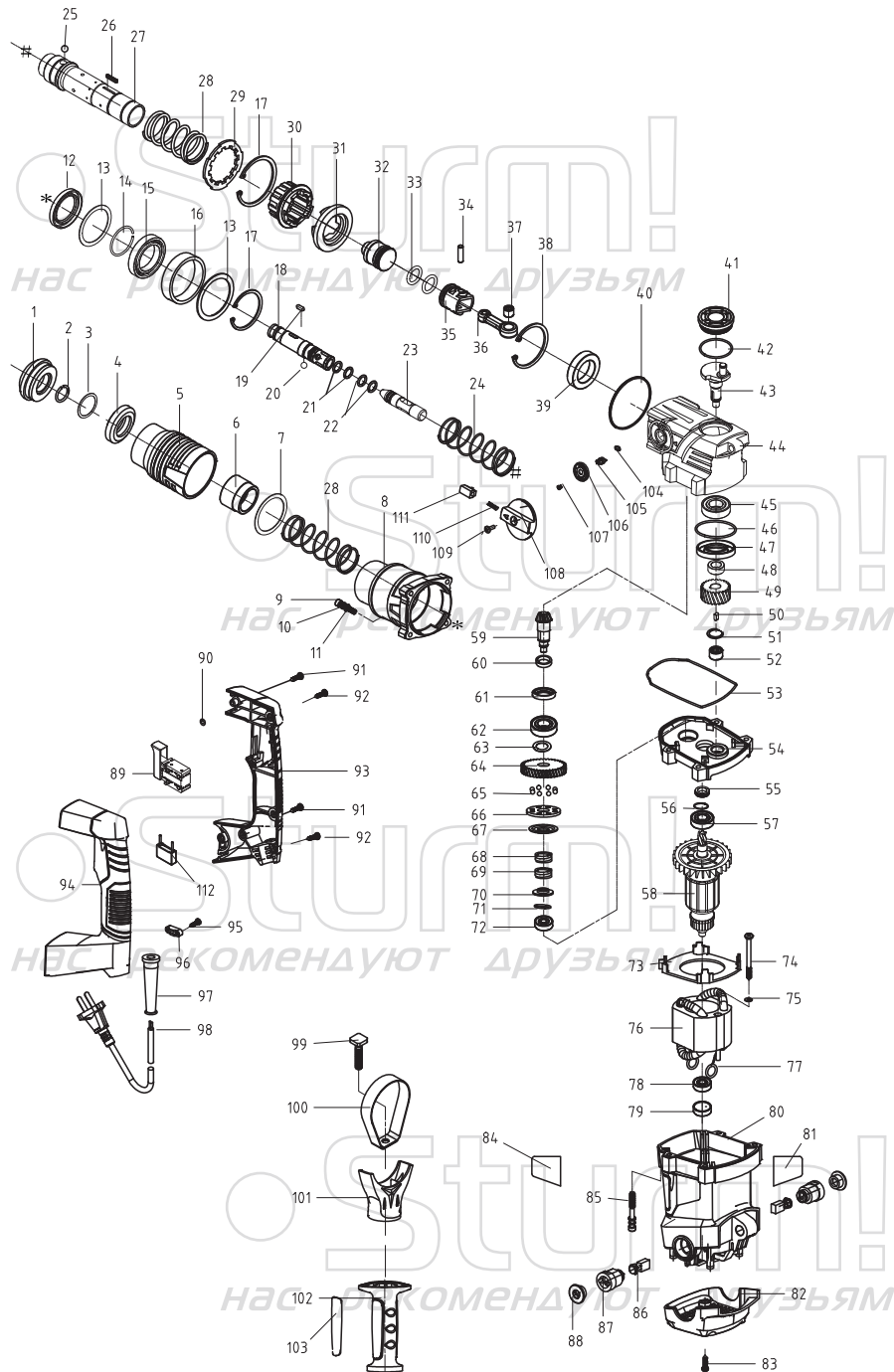

NO.	DESCRIPTION	NO.	DESCRIPTION
1	Front cap	57	Bearing 6201
2	steel wire retainer ring $\Phi 25 \times 2$	58	Rotor
3	limite Washer 27.8*38.5*2.5	59	Third Gear
4	damping washer	60	Range ring 15*19*4
5	Slippage Clamp	61	Oil Seal 19*28*4.5
6	quick connector	62	Bearing 6002
7	Wash 38.5*54.5*2	63	Shim
8	Cylinder case	64	Gear
9	Hex type socket screw M6x30	65	Stell 'Ball 5
10	Spring washer $\Phi 6$	66	Tripping block
11	Flat washer $\Phi 6$	67	Tripping plate
12	Oil Seal 55*40*8	68	Tripping Spring $\Phi 2.8 \times \Phi 17.5 \times 15$
13	Wash 48*62*1.5	69	Tripping Spring $\Phi 2.8 \times \Phi 17.5 \times 15$
14	Steel wire retainer ring 37*40*2	70	Spring seat
15	Bearing 61908	71	Shaft wrie tetaining ring
16	Distance Ring 55*62*14	72	Bearing 627
17	Spring retainer ring $\Phi 62$	73	Led Wind Ring
18	Rotate sheath	74	Self-threading screw ST5*60
19	Ball pin 8*19.25	75	Flat washer $\Phi 5$
20	Stell 'Ball 9	76	Stator
21	O Ring 26*2	77	tension spring
22	O Ring 15*2	78	Bearing 608
23	Impact Bolt	79	Bearing cap 608
24	Spring 61*1.5*40	80	Motor housing
25	Stell Ball $\Phi 9$	81	Labeling
26	Flat Key 3*3*18	82	rear cover
27	Cylinder	83	screw ST4*14
28	Spring 41.5*2.5*75	84	nameplate
29	Lock washer	85	socket screw M6x55
30	Buffer washer	86	carbon brush
31	Big angle gear	87	brush holder
32	Striker	88	brush cap
33	O Ring 23.2*3.5	89	Swith
34	Piston Pin 8*28.8	90	O Ring 8*3.5
35	Piston	91	screw ST4*20
36	Connecting Rod	92	screw ST4*20
37	N/A	93	Left handle
38	Spring retainer ring $\Phi 55$	94	Right handle
39	Oil Bearing $\Phi 34 \times \Phi 55 \times 10$	95	screw ST4*16
40	O Ring $\Phi 65 \times 1.3$	96	Relief plate
41	Oil Cap	97	cord guard
42	O Ring $\Phi 47 \times 2$	98	power cord
43	Crank shaft	99	Screw M8*45
44	Gearbox	100	fastening belt
45	Bearing 6303	101	supporting bracket
46	O Ring $\Phi 46.5 \times 2$	102	auxiliary handle
47	Oil Seal $\Phi 24 \times \Phi 47 \times 7$	103	fixture block
48	Distance Ring 17*24*8	104	O Ring $\Phi 12 \times 2$
49	Gear	105	knob handle
50	Flat Key 4*4*12	106	knob seat
51	Stop wash	107	Tapping Screw M4*10
52	Needle Bearing H1208	108	Knob
53	Gasket Ring	109	Tapping Screw M4*16
54	Middle cover	110	Spring 4.5*0.6*25
55	Oil Seal 22*12*5	111	Self-looking knob
56	O Ring $\Phi 31.5 \times 2$	112	capacitor